

NOTE:  
 1 - Earth fills greater than 15" shall be constructed in layers of 12" max. If of City Ord. of Highway 34. Specification dated Jan. 1949  
 2 - Road or above speed limit will not comply on road as to provisions of City of San Bernardino Specification No. 2027

TYPICAL SECTION  
 CURB, RETURN & FOOTWALL Bldg.


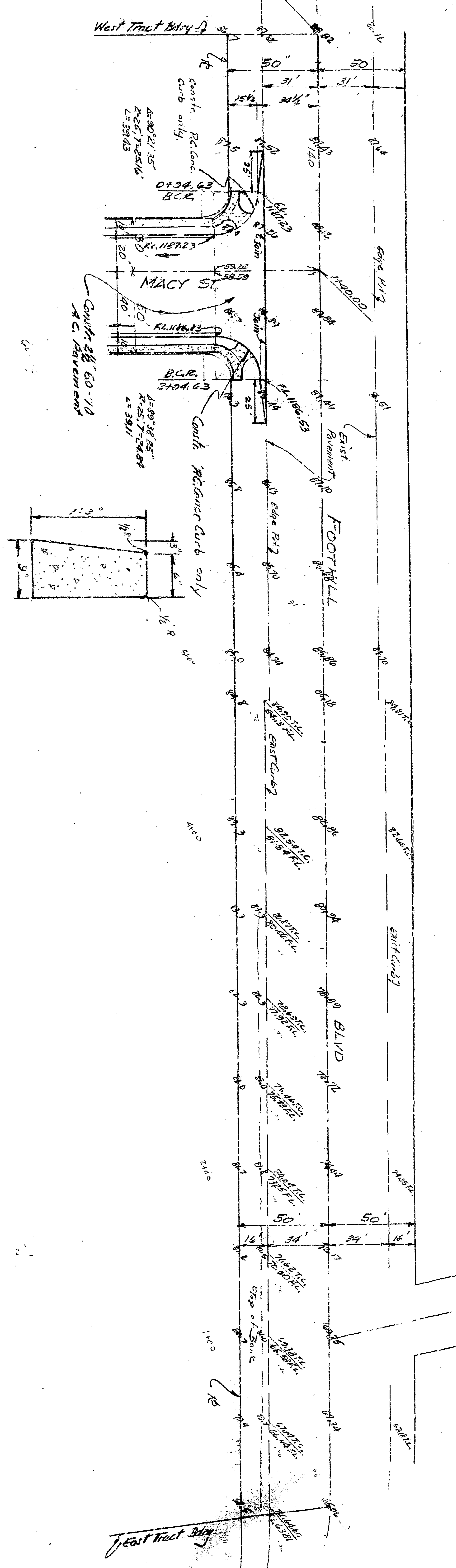

DATE: 11/15/53  
 DRAWN BY: [illegible]  
 CHECKED BY: [illegible]  
 SCALE: AS SHOWN

NOV 1953